

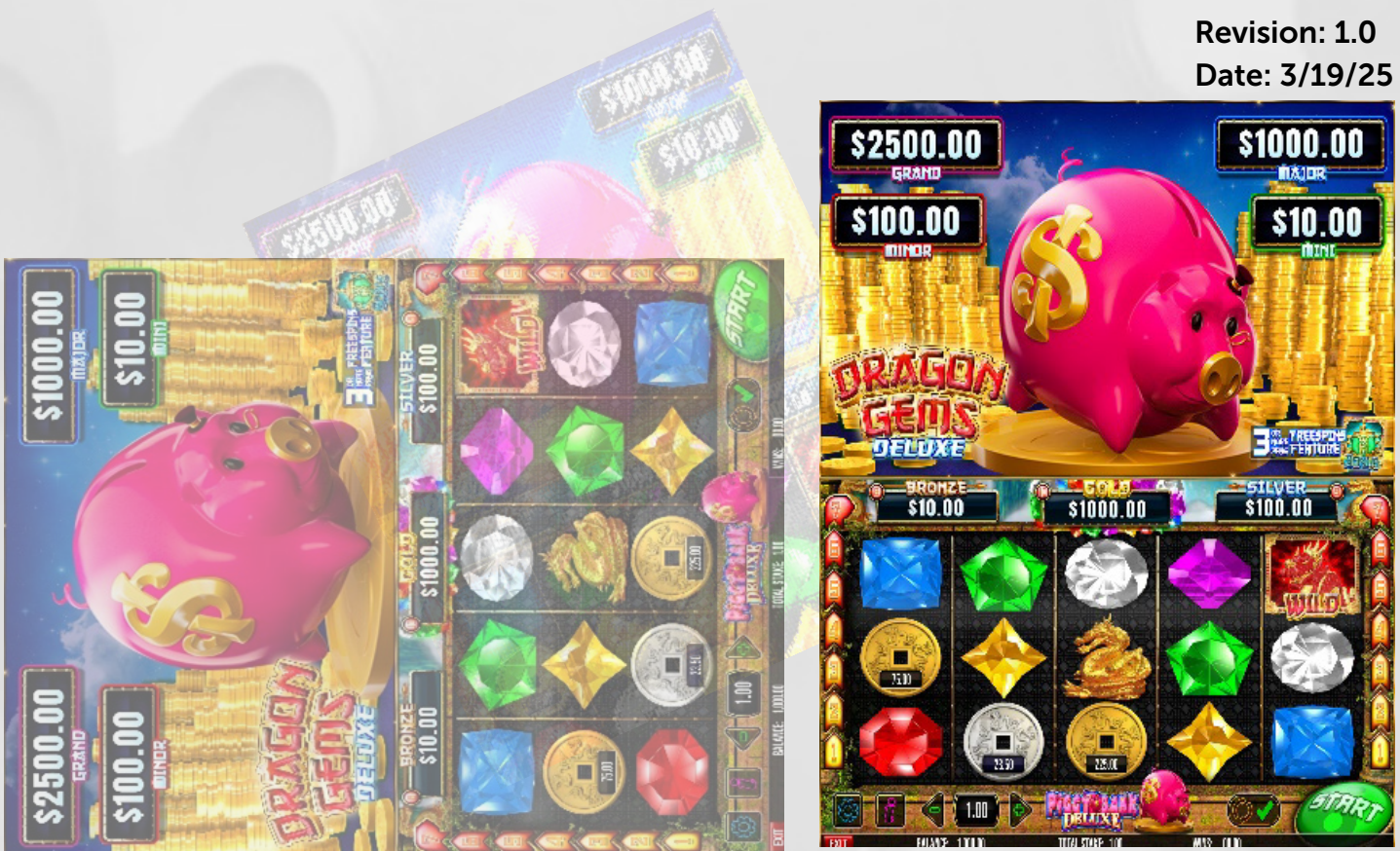

Screen Orientation

For Piggy Bank Deluxe on EFCO Boards

Revision: 1.0
Date: 3/19/25





Screen Orientation

Disclaimer

The information contained in this instruction manual is for information purposes only. Primero Games, LLC ("Primero") is not responsible for any errors or omissions, or for the results obtained, from the use of this information. All information in this instruction manual is presented "as is" with no guaranty of completeness, accuracy, or for the results obtained from its use. This instruction manual is not intended to be a safety guide. You must take all safety precautions that you believe are necessary. Your use of this information is at your own risk. This instruction manual is not a product warranty. PRIMERO MAKES NO EXPRESS OR IMPLIED WARRANTY AND DISCLAIMS ALL OTHER WARRANTIES WITH RESPECT TO THE INFORMATION CONTAINED HEREIN.

Version	Author / Contributors	Date	Changes / Comments
1.0	Shawn Lucci – Technical Writer Johnny Davis – Service & Support Supervisor	3.19.25	Original Document



Screen Orientation

Method 1

1. Insert and Turn the Operator Menu Key.

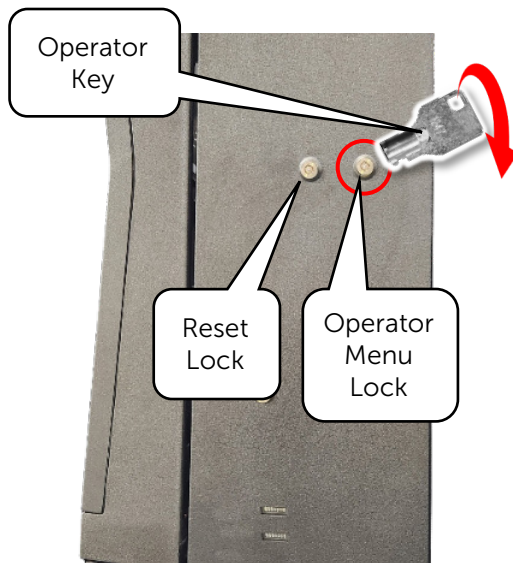

The PINCODE Login Appears on the Screen.

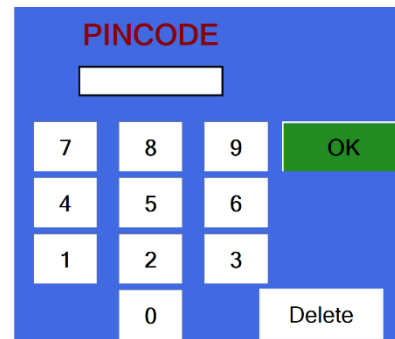

2. Tap the Play button to Rotate the Screen.

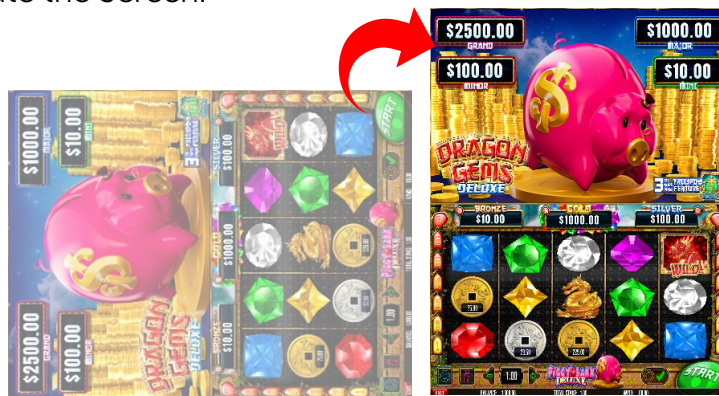



Screen Orientation

Method 2

If Method 1 does not work, the following instructions should apply a fix via Windows to correct the Screen Orientation issue.



Note: For cabinets with Dual Monitors, it will be necessary to disconnect the Top Monitor prior to accessing the Display Settings.

Disconnect
Top Monitor

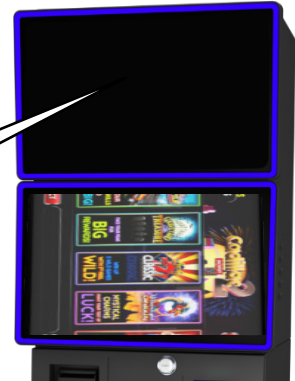

1. Plug a Windows Keyboard and Mouse into the board using any open USB Ports.



Note: A windows keyboard is not necessary, but helpful and a Keyboard / Mouse combination is acceptable.





Screen Orientation

2. On the Keyboard, press the Alt key and F4 together.
The Game will stop, and the screen should turn Black.

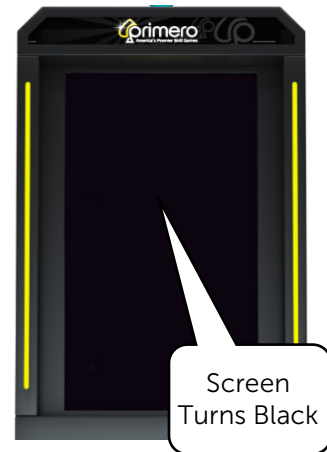

Note: Some keyboards may require a Function Key (FN) be pressed and held for the F4 key to engage.

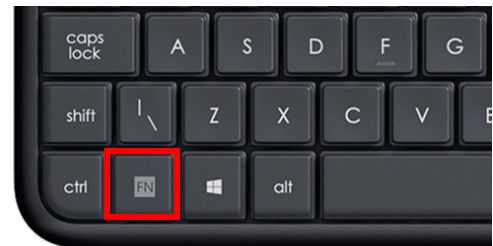

3. Press Ctrl, Shift and Esc to bring up the Task Manager.

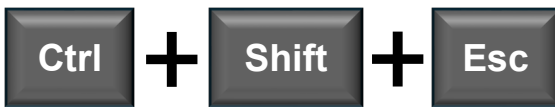

Task Manager Opens

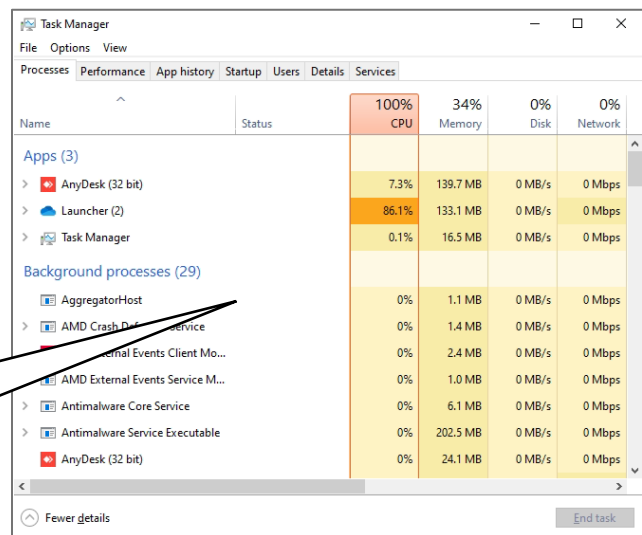



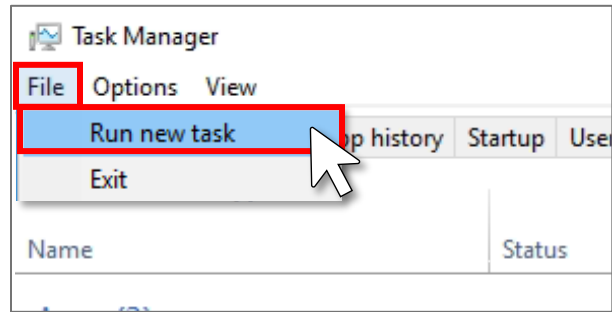

Screen Orientation

4. In the Task Manager, Click on File and Select "Run new task."

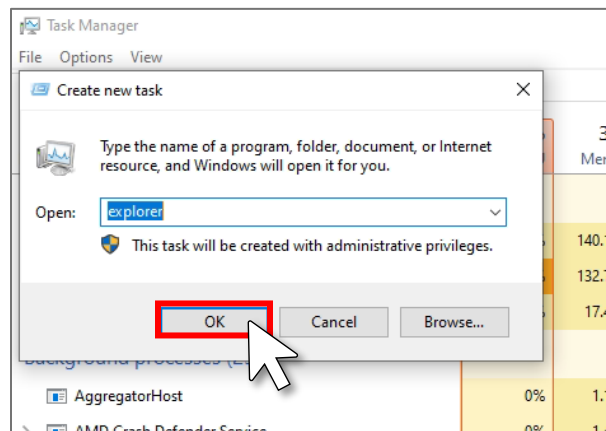

5. The Create new task window will open and should default to Open "explorer." Click OK.



 **Note:** If "explorer" does not appear in the Open field, enter it before clicking OK.

The screen will turn Purple with the game background.

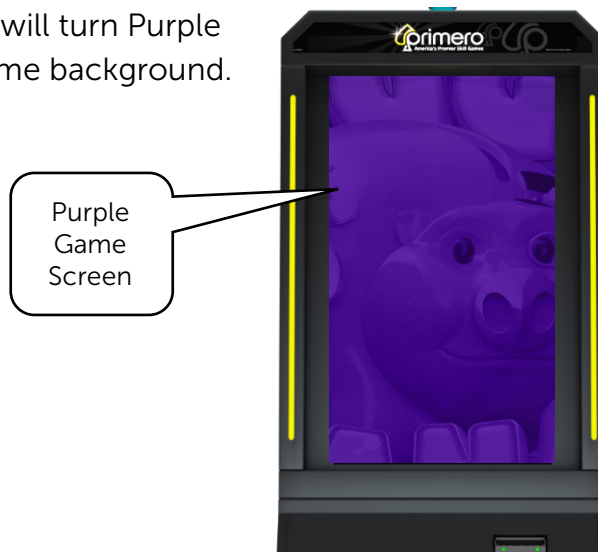



Screen Orientation

6. Press the Windows Key and the letter I on the keyboard to open the Settings Menu.

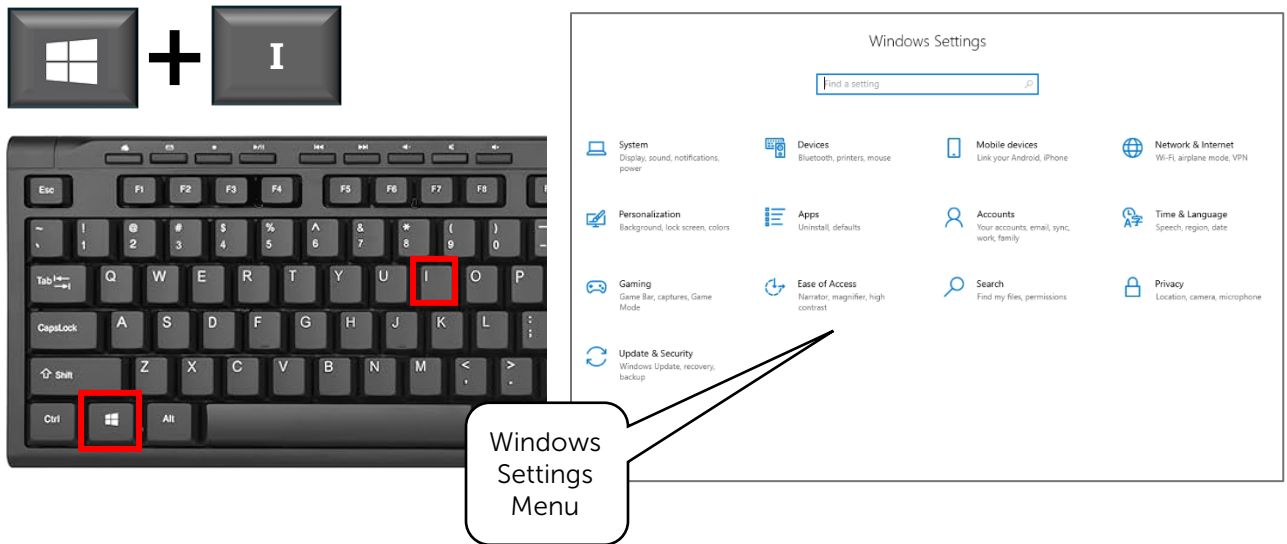

7. In the Windows Settings Menu, Click on System.

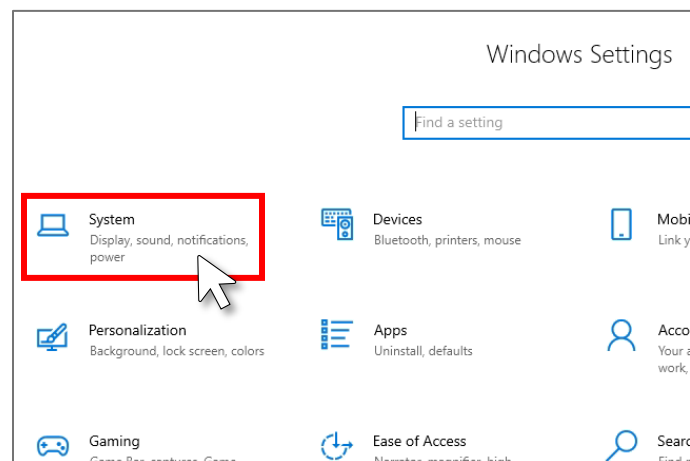

The System Settings menu will open and should default to Display, if not, click Display on the left-side menu.

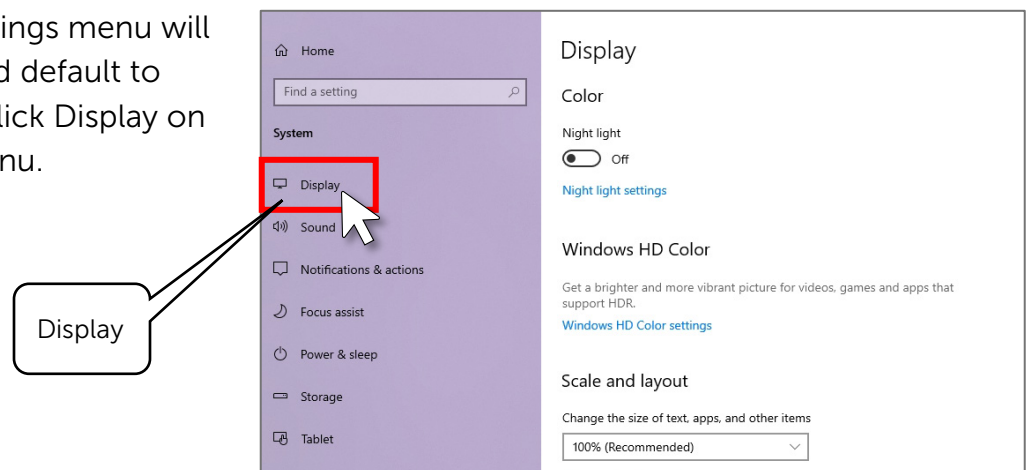



Screen Orientation

8. Under the Scale and layout section, Click the Display Orientation dropdown and Select Portrait.

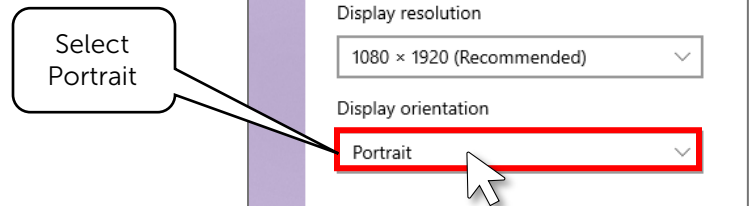

9. A message will pop up asking to Keep these display settings, Click Keep changes.

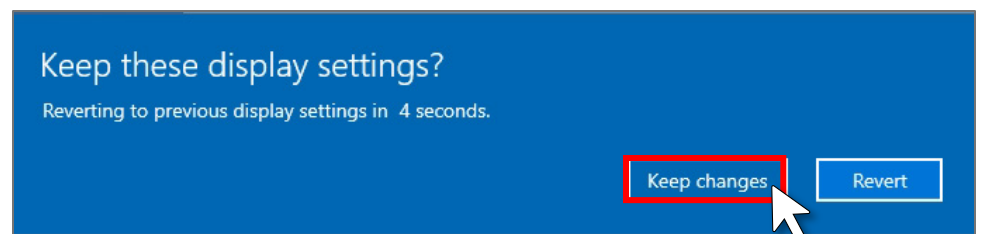

10. Press the Windows Key to open the Power Settings and Click Restart.

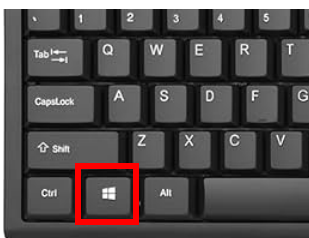

Click
Restart

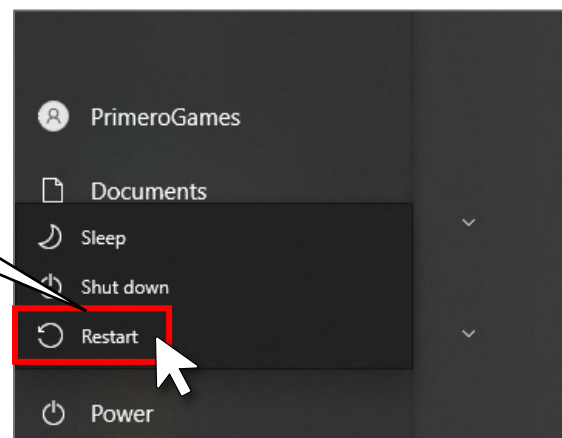



Screen Orientation

The Machine will reboot, and the Screen Orientation should be correct.

Screen Orientation Correct

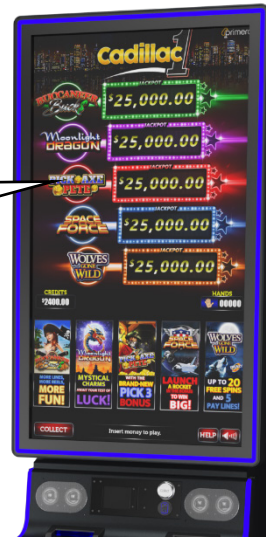

Note: If necessary, power off the cabinet and reconnect the Top Monitor.

Reconnect Top Monitor



For assistance, please call Primero Support at **833-503-1724** or scan the QR Code for more documentation at <https://support.primerogames.com>.

